

Lock Nuts

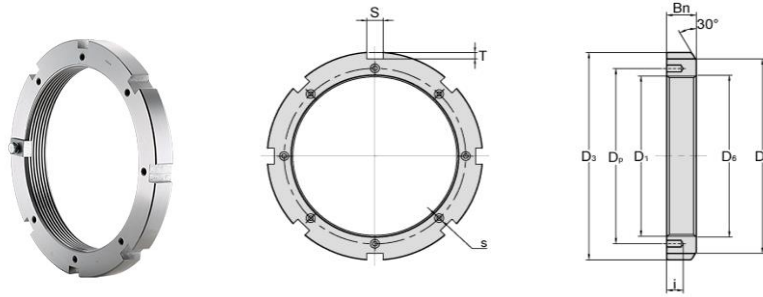

**ANL
HM 30**

Lock Nuts NO.	D1	D3	D4	S	T	D6	Bn	i	Tapped Holes	Dp	Suitable Lock plates	Weight
	Thread ¹⁾	mm	mm	mm	mm	mm	mm	mm	Threads	mm	No.	kg
ANL44	Tr220*4	260	242	20	9	222	30	12	M6*1	229	ALL44	3.09
ANL48	Tr240*4	290	270	20	10	242	34	15	M8*1.25	253	ALL48	5.16
ANL52	Tr260*4	310	290	20	10	262	34	15	M8*1.25	273	ALL52	5.67
ANL56	Tr280*4	330	310	24	10	282	38	15	M8*1.25	293	ALL56	6.78
ANL60	Tr300*4	360	336	24	12	302	42	15	M8*1.25	316	ALL60	9.62
ANL64	Tr320*5	380	356	24	12	322.5	42	15	M8*1.25	335	ALL64	9.94
ANL68	Tr340*5	400	376	24	12	342.5	45	15	M8*1.25	355	ALL68	11.7
ANL72	Tr360*5	420	394	28	13	362.5	45	15	M8*1.25	374	ALL72	12
ANL76	Tr380*5	450	422	28	14	382.5	48	18	M10*1.5	398	ALL76	14.9
ANL80	Tr400*5	470	442	28	14	402.5	52	18	M10*1.5	418	ALL80	16.9
ANL84	Tr420*5	490	462	32	14	422.5	52	18	M10*1.5	438	ALL84	17.4
ANL88	Tr440*5	520	490	32	15	442.5	60	21	M12*1.75	462	ALL88	26.2
ANL92	Tr460*5	540	510	32	15	462.5	60	21	M12*1.75	482	ALL92	29.6
ANL96	Tr480*5	560	530	36	15	482.5	60	21	M12*1.75	502	ALL96	28.3
ANL100	Tr500*5	580	550	36	15	502.5	68	21	M12*1.75	522	ALL100	33.6

Tr means 30°, trapezoid thread and the digits are major diameter of thread and pitch.

NOTE: The specifications of ANL can be applied for HM30.