

## Lock Nuts

AN  
HM 31

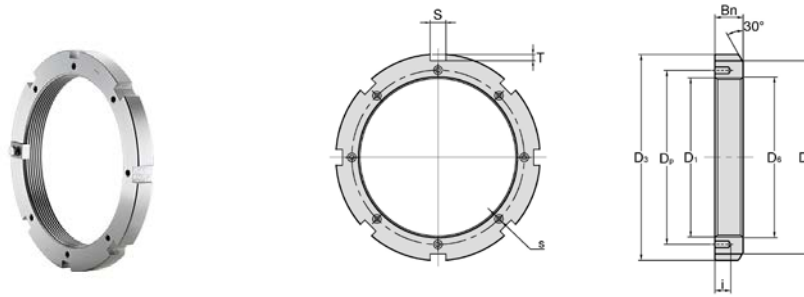

Lock Nuts NO.	D1	D3	D4	S	T	D6	Bn	i	Tapped Holes	Dp	Suitable	Weight
	Thread <sup>1)</sup>	mm	mm	mm	mm	mm	mm	mm	Threads	mm	Lock plates No.	
AN44	Tr220*4	280	250	20	10	222	32	15	M8*1.25	238	AL44	5.2
AN48	Tr240*4	300	270	20	10	242	34	15	M8*1.25	258	AL48	5.95
AN52	Tr260*4	330	300	24	12	262	36	18	M10*1.5	281	AL52	8.05
AN56	Tr280*4	350	320	24	12	282	38	18	M10*1.5	301	AL56	9.05
AN60	Tr300*4	380	340	24	12	302	40	18	M10*1.5	326	AL60	11.8
AN64	Tr320*5	400	360	24	12	322.5	42	18	M10*1.5	345	AL64	13.1
AN68	Tr340*5	440	400	28	15	342.5	55	21	M12*1.75	372	AL68	23.1
AN72	Tr360*5	460	420	28	15	362.5	58	21	M12*1.75	392	AL72	25.1
AN76	Tr380*5	490	440	32	18	382.5	60	21	M12*1.75	414	AL76	30.9
AN80	Tr400*5	520	460	32	18	402.5	62	27	M16*2	439	AL80	36.9
AN84	Tr420*5	540	490	32	18	422.5	70	27	M16*2	459	AL84	43.5
AN88	Tr440*5	560	510	36	20	442.5	70	27	M16*2	477	AL88	45.3
AN92	Tr460*5	580	540	36	20	462.5	75	27	M16*2	497	AL92	50.4
AN96	Tr480*5	620	560	36	20	482.5	75	27	M16*2	527	AL96	62.2
AN100	Tr500*5	630	580	40	23	502.5	80	27	M16*2	539	AL100	63.3

Tr means 30°, trapezoid thread and the digits are major diameter of thread and pitch.

Note: The specifications of AN can be applied for HM31.