

Lock Nuts

HM
HN

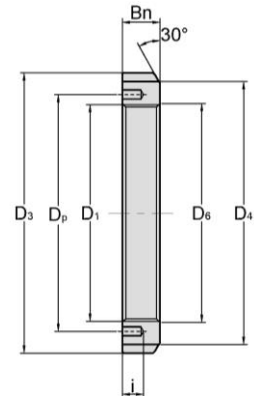
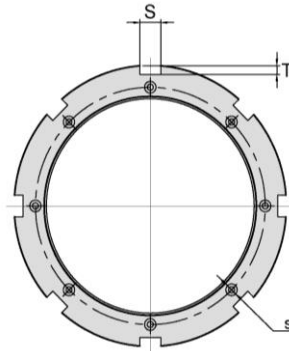

Lock Nuts NO.	D1 Thread ¹⁾	D3 mm	D4 mm	Bn mm	S mm	T mm	D6 mm	Weight kg
HM42	Tr210*4	270	238	30	20	10	212	4.75
HM44	Tr220*4	280	250	32	20	10	222	5.35
HM46	Tr230*4	290	260	34	20	10	232	5.8
HM48	Tr240*4	300	270	34	20	10	242	6.2
HM50	Tr250*4	320	290	36	20	10	252	7
HM52	Tr260*4	330	300	36	24	12	262	8.55
HM54	Tr270*4	340	310	38	24	12	272	9.2
HM56	Tr280*4	350	320	38	24	12	282	10
HM58	Tr290*4	370	330	40	24	12	292	11.8
HM60	Tr300*4	380	340	40	24	12	302	12
HM62	Tr310*5	390	350	42	24	12	312.5	13.4
HM64	Tr320*5	400	360	42	24	12	322.5	13.5
HM66	Tr330*5	420	380	52	28	15	332.5	20.4
HM68	Tr340*5	440	400	55	28	15	342.5	24.5
HM70	Tr350*5	450	410	55	28	15	352.5	25.2
HM72	Tr360*5	460	420	58	28	15	362.5	27.5
HM74	Tr370*5	470	430	58	28	15	372.5	28.2
HM76	Tr380*5	490	440	60	32	18	382.5	33.5
HM80	Tr400*5	520	460	62	32	18	402.5	40
HM84	Tr420*5	540	490	70	32	18	422.5	46.9
HM88	Tr440*5	560	510	70	36	20	442.5	48.5
HM92	Tr460*5	580	540	75	36	20	462.5	55
HM96	Tr480*5	620	560	75	36	20	482.5	67
HM100	Tr500*5	630	590	80	40	23	502.5	69
HM102	Tr510*6	650	590	80	40	23	513	75
HM106	Tr530*6	670	610	80	40	23	533	78
HM110	Tr550*6	700	640	80	40	23	553	92.5

Tr means 30°, trapezoid thread and the digits are major diameter of thread and pitch.

NOTE: The specifications of HM can be applied for HN.