

SPW

自潤 #500SP

止推墊圈 (SPW)

*請參考SPB組配

*可與SPB合併使用

訂購型號: **SPW-XX XX**
ID Thickness



尺寸 (mm)		厚度T			公差 $\begin{matrix} -0 \\ -0.1 \end{matrix}$
內徑	外徑	3	5	7	8
Ød	ØD	SPW	SPW	SPW	SPW
10.2	30	-1003			
12.2	40	-1203			
12.2	40	-1203N			
13.2	40	-1303			
14.2	40	-1403			
15.2	50	-1503			
16.2	50	-1603			
16.2	50	-1603N			
18.2	50	-1803			
20.2	50		-2005		
25.2	55		-2505		
30.2	60		-3005		
35.2	70		-3505		
40.2	80			-4007	
45.2	90			-4507	
50.3	100				-5008
55.3	110				-5508
60.3	120				-6008
65.3	125				-6508
70.3	130				
75.3	140				
80.3	150				
90.5	170				
100.5	190				
120.5	200				

自潤 #500SP
止推墊圈 (SPW)

*請參考SPB組配
*可與SPB合併使用

訂購型號: **SPW-XX XX**
ID Thickness

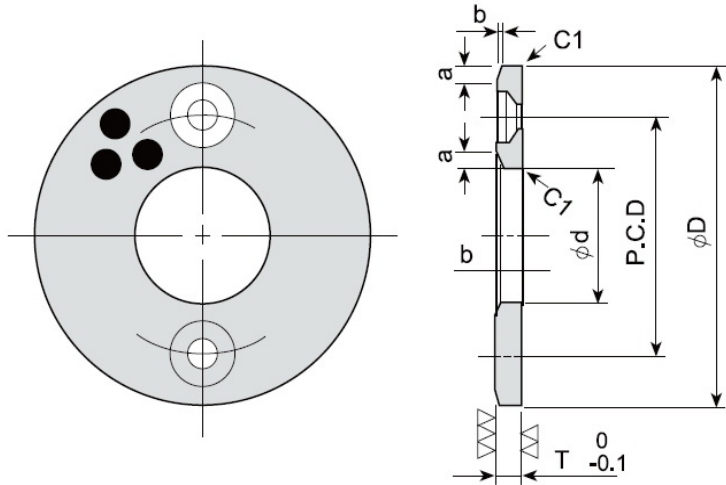

公差 $\begin{matrix} -0 \\ -0.1 \end{matrix}$	裝配孔			倒角	
	10				
SPW	P.C.D	個數	使用埋頭螺栓	a	b
	20	2	M3	1.5	0.3
	28	2	M3	2	0.4
		no countersunk bolt hole		2	0.4
	28	2	M3	2	0.4
	28	2	M3	2	0.4
	35	2	M3	2	0.4
	35	2	M3	2	0.4
		no countersunk bolt hole		2	0.4
	35	2	M3	2	0.4
	35	2	M5	2.5	0.4
	40	2	M5	2.5	0.4
	45	2	M5	2.5	0.4
	50	2	M5	2.5	0.4
	60	2	M6	3	0.5
	70	2	M6	3	0.5
	75	4	M6	4	0.6
	85	4	M6	4	0.6
	90	4	M8	5	0.8
	95	4	M8	5	0.8
-7010	100	4	M8	5	0.8
-7510	110	4	M8	5	0.8
-8010	120	4	M8	5	0.8
-9010	140	4	M10	5	0.8
-10010	160	4	M10	5	0.8
-12010	175	4	M10	5	0.8